

PIVOT Handset

344032

Description

2 WIRE PIVOT handset for wall mounted, flush mounted, or table top installation. It has door lock release, staircase light and EP activation keys.

The device offers the possibility of selecting among 16 already programmed bells for floor call, main entrance panel, INTERCOM CALL, and secondary entrance panel. The call volume can be set on three levels: high, medium and disabled (this condition is signalled by a flashing red LED).

It also has a call secrecy function. It is connected to the system using the removable clamp supplied.

Wall mounting bracket supplied as standard.

WARNING: Table installation is possible in video or mixed audio/video systems where the wiring to the handset uses floor shunt 346841 or the audio/video node F441.

Related items

346812	4 key small block for auxiliary functions - white
337102	table-top support - white

NOTE: for flush mounted installation refer to the specific accessories of the **MULTIBOX** range.

Technical data

Power supply from SCS BUS:	18 – 27 Vdc
Stand by absorption:	5 mA
Max. operating absorption:	35 mA
Operating temperature:	5 - 40°C

Dimensional data

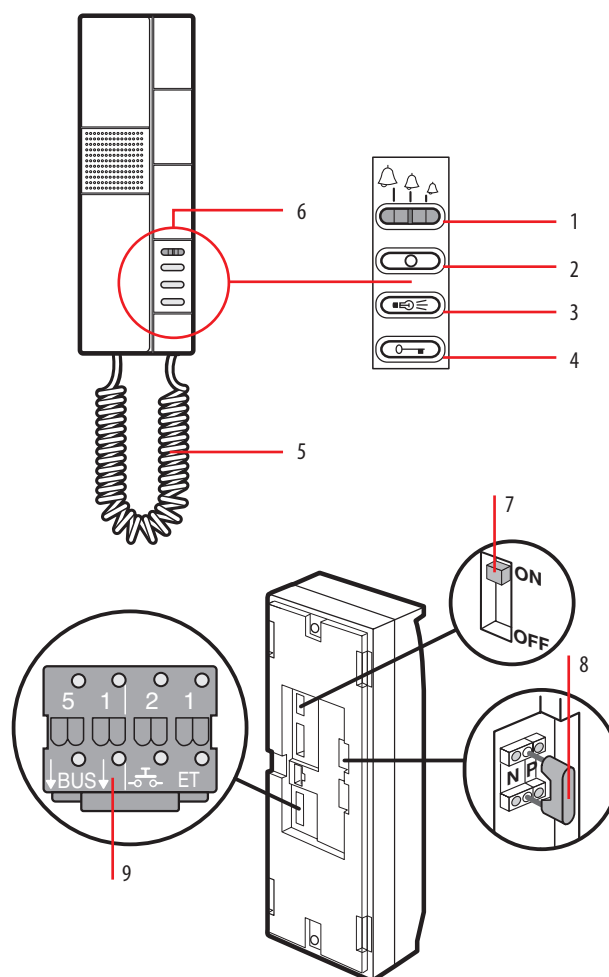
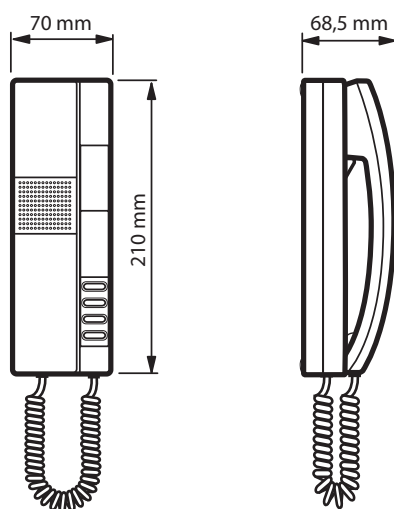

Legend



- 1 - electronic call with volume adjustable on 3 levels: high, medium, disabled (the excluded call is signalled by a flashing red LED).
- 2 - Entrance panel activation
- 3 - Staircase light key
- 4 - Door lock key
- 5 - Extensible cord capped on both ends with RJ connectors
- 6 - Socket for 4 key small block (optional)
- 7 - Line termination ON/OFF micro-switch
- 8 - Configurator socket
- 9 - Plug-in clamp for the connection of the 2 WIRE BUS, additional power supply, and auxiliary floor call function, as well as extra bell.

Configuration

N – handset number

The N configurator assigns to each handset an identification number within the system. The handsets must be configured in progressive order. In case of handsets with parallel connection (max 3 inside the same apartment without 346850), these must be configured using the same N configurator.

P – entrance panel association

The P configurator identifies the associated EP or the first entrance panel on which the audio is activated when the  key is pressed for the first time, as well as which door lock is activated when the  key is pressed while the handset is idle.

Configurator in P	key function
0-9	Activation of the audio function on the entrance panel (configured with P=0-9)

Configurator in P	key function
0-9	Entrance panel door lock release with handset idle

Programming of bells

Bell selection from MAIN ENTRANCE
PANEL (S=0 - S=4)

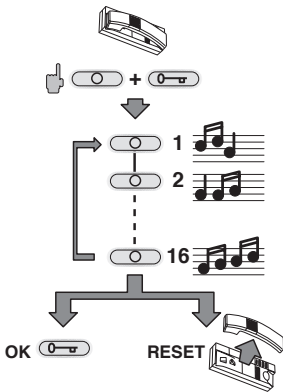

Bell selection from SECONDARY
ENTRANCE PANEL (S=0 - S=5)

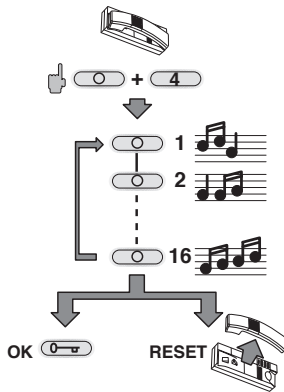

FLOOR CALL bell selection

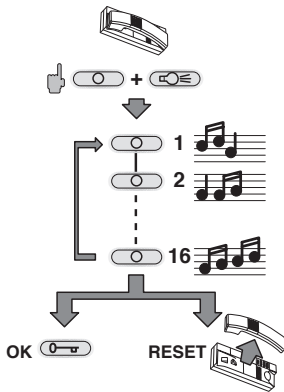

INTERCOM CALL bell
selection

